

REFRIGERATOR MANUFACTURER
Turbo air
 more durable, convenient, beautiful

1250 Victoria St
 Carson, CA 90746
 Tel. 310-900-1000
 Fax. 310-900-1077
www.turboairinc.com

Project :	
Model # :	
Item # :	Qty :
Available W/H :	
Approval :	

Glass Door Freezer

Glass Door Merchandisers
 Super Deluxe Series

FEATURES / BENEFITS

Model : TGF-72SD

■ SMART DEFROST SYSTEM

Generally, a refrigerator's defrost timer defrosts automatically for a fixed length of time regardless of the existing conditions of the refrigerator. This makes it difficult to maintain a constant temperature and also consumes unnecessary energy. Turbo Air's "Smart Defrost System" analyzes its surrounding environments and defrosts only when it is needed for the required time. This not only saves energy but also keeps the contents of the refrigerator safe.

■ NO ELECTRICAL FRAME HEATER IS NEEDED

Turbo Air is the first in the industry to replace a frame heater with a method of using compressor-produced heat. This eliminates any unnecessary energy consumption while providing efficient freezing performance.

■ ENERGY CONSERVING FAN CONTROL

Utilizing algorithmic air circulation for optimal temperature levels, our innovative fan control system conserves energy by at least 15% and increases compressor life by up to 30%.

■ LED LIGHTING INTERIOR DISPLAY SYSTEM

Brighter and longer lasting LED lights provide attractive, enhanced illumination compared to fluorescents. It saves energy by producing less heat, while maximizing the visibility in the display area.

■ SHADOW FREE ADVERTISING PANEL

Turbo Air is the pioneer in the refrigerator industry on applying special LED Light Guided Panels (LGP). LGP increases panel visibility and eliminates shadows, thus enhances any store atmosphere with eye-catching effects. LED lighting offers 10 times longer lasting life than fluorescents and conserves energy as well.

■ MODERN DESIGN

By harmonizing curvature and rigidity, our modern style product designs are user-friendly while maintaining the highest product visibility and aesthetics.

■ DOOR OPENING ALARM

If the doors are not tightly closed, the refrigerator will not run. This would cause the cold air to escape through the opening, making food products spoil inside the cabinet. To prevent this problem, our refrigerators are equipped with the Door Alarm System that will sound if the doors are left open for more than 30 seconds.

■ EARLY WARNING SYSTEM

Malfunctions are generally recognized when an increase in temperature is detected, 2 to 3 hours after the refrigerator had stopped running. This causes the user to become aware of malfunction issues the next morning in which the contents may have already spoiled. To eliminate this, Turbo Air units have a warning system in place that diagnose and monitor itself for risk factors, which gives early warning signals to allow for preserving contents and for preventing future problems.

■ SOUND SYSTEM

plays music and recorded greetings when customer opens the doors

■ TRIPLE PANE AIR INSULATED LAYER GLASS DOORS

Equipped with unique triple pane glass doors with a layer of patented, transparent thermal insulating film applied between the glass layers. Lightweight door construction reduces door maintenance and roller/bushing wear, and facilitates smooth door opening.

■ AUTOMATIC CONDENSER CLEANING SYSTEM (OPTIONAL)

The accumulation of dust in the condenser causes the failure or breakdown of refrigerators. Especially for freezers, they run normally until they reach a certain level of accumulation. At some point, when they are over the limit, their performance drops quickly resulting in damage to, or disposal of the stored products in freezers. The automatic condenser cleaning system keeps the condenser clean and prevents system failure by automatically brushing daily.

**EXCEPTIONAL 3 YEAR
 PARTS & LABOR WARRANTY**



■ INDIVIDUAL TWO CYCLE REFRIGERATION SYSTEM

■ FREEZER HOLDS -15°F ~ 5°F FOR THE BEST IN FROZEN FOOD PRESERVATION



ENERGY STAR®
 Qualified

Model	Swing Door	CU./FT.	#of Shelves	HP	AMPS	Crated Weight (lbs.)	L x D* x H† (inches)
TGF-72SD	3	71.3	12	1 1/4 x 2	15.2	832	78 x 31 7/8 x 77

Model : TGF-72SD

ELECTRICAL DATA	
Voltage †	115/208~230/60/1
Plug Type †	Ⓢ NEMA-L14-20
Full Load Amperes	15.2
Compressor HP	1 1/4 X 2
Cord Length ft.	7
Refrigerant	R-404A
DIMENSIONAL DATA	
# of Doors	3
Net Capacity cu. ft.	71.3
Ext. Length Overall in.	78 (1981mm)
Ext. Depth Overall in.*	31 7/8 (809mm)
Ext. Height Overall in. †	77 (1956mm)
Int. Length Overall in.	74 1/2 (1891mm)
Int. Depth Overall in.	27 7/8 (709mm)
Int. Height Overall in.	61 1/4 (1556mm)
Gross Weight lbs.	832
Net Weight lbs.	800
# of Shelves	12
Shelf Size (LxD) in.	22 1/2 x 23 3/8, 24 5/8 x 23 3/8

Design and specifications subject to change without notice.
Actual shipping weight may differ due to extra packing materials for product protection.

* Depth does not include 2-1/4" (57mm) for door handle.

† Height does not include 2-1/2" (63mm) for leg height.

‡ TGF-72SD requires dual voltage 115/208-230/60Hz, single phase, 3 pole, 4 wire circuit (NEMA-L14-20).

- **WARRANTY :** Exceptional 3 Year Parts and Labor Warranty
Additional 2 Year Warranty on Compressor

- **THREE COLOR OPTIONS AVAILABLE**

- Black Cabinet
- White Cabinet
- White Cabinet with Wine Color Trim

- **DOOR LOCKING SYSTEM STANDARD**

- **PRICE TAG ATTACHABLE SHELF AVAILABLE (OPTIONAL)**

PLAN VIEW

(unit : inch)

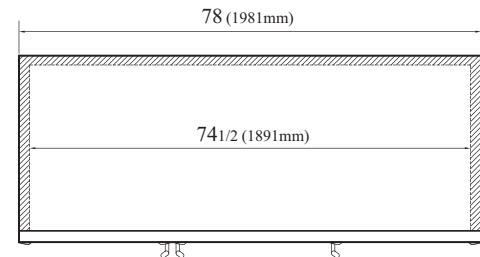

TOP VIEW

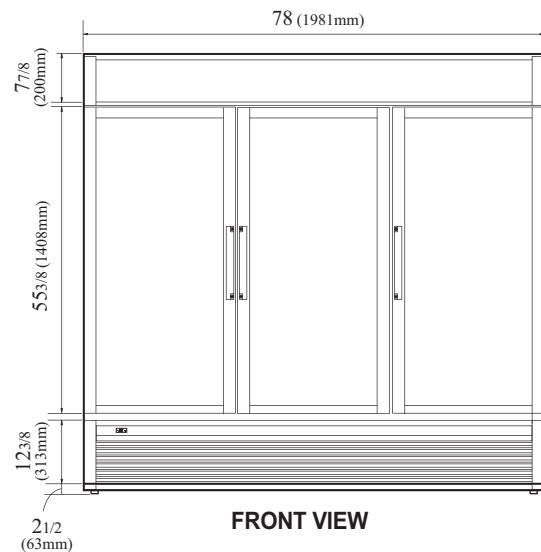

FRONT VIEW

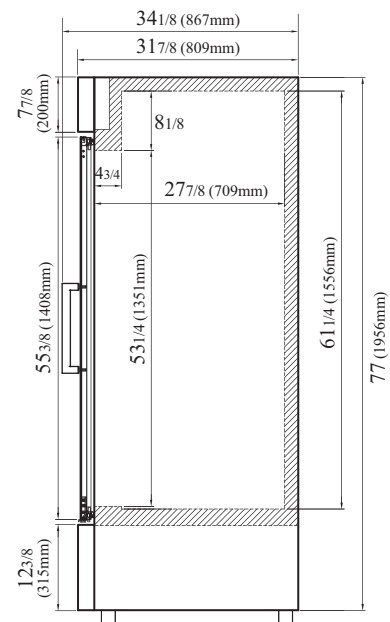

SIDE VIEW

Ver.201301



ENERGY STAR®
Qualified

- Turbo Air : 800-627-0032
- GK : 800-500-3519
- Warranty : 800-381-7770
- AC : 888-900-1002

