

REFRIGERATOR MANUFACTURER
Turbo air
 more durable, convenient, beautiful

1250 Victoria St
 Carson, CA 90746
 Tel. 310-900-1000
 Fax. 310-900-1077
www.turboairinc.com

Project :	
Model # :	
Item # :	Qty :
Available W/H :	
Approval :	

Glass Door Freezer

Glass Door Merchandisers
 Super Deluxe Series

Model : TGF-5SD

FEATURES / BENEFITS

- **LED LIGHTING INTERIOR DISPLAY SYSTEM**
 Brighter and longer lasting LED lights provide attractive, enhanced illumination compared to fluorescents. It saves energy by producing less heat, while maximizing the visibility in the display area.
- **MODERN DESIGN**
 By harmonizing curvature and rigidity, our modern style product designs are user-friendly while maintaining the highest product visibility and aesthetics.
- **TRIPLE PANE AIR INSULATED LAYER GLASS DOORS**
 Equipped with unique triple pane glass doors with a layer of patented, transparent thermal insulating film applied between the glass layers. Lightweight door construction reduces door maintenance and roller/bushing wear, and facilitates smooth door opening.
- **NO ELECTRICAL FRAME HEATER IS NEEDED**
 Turbo Air is the first in the industry to replace a frame heater with a method of using compressor-produced heat. This eliminates any unnecessary energy consumption while providing efficient freezing performance.
- **EFFICIENT REFRIGERATION SYSTEM**
 Turbo Air's freezers are designed with oversized and balanced (CFC Free R-404A) refrigeration systems. These include efficient evaporators and condensers for faster freezing and greater efficiency.
- **HIGH-DENSITY POLYURETHANE INSULATION**
 The entire cabinet structure is foamed-in-place using high density, CFC free polyurethane insulation.
- **ERGONOMICALLY DESIGNED DOORS**
 Customers' fatigue fades away with easy grip handles and doors that open effortlessly. These features along with self-closing doors make this the ultimate choice in customer convenience.
- **MAGNETIC DOOR GASKETS**
 Magnetic door gaskets are of one piece construction, removable without tools for ease of cleaning and replacement.
- **ADJUSTABLE, HEAVY DUTY, PE(POLYETHYLENE) COATED WIRE SHELVES**
- **FREEZER HOLDS -15°F ~ 5°F FOR THE BEST IN FROZEN FOOD PRESERVATION**

EXCEPTIONAL 3 YEAR PARTS & LABOR WARRANTY



Model	Swing Door	CU./FT.	#of Shelves	HP	AMPS	Crated Weight (lbs.)	L x D* x H† (inches)
TGF-5SD	1	5.9	2	1/3	5.5	185	25 x 23 1/4 x 30 1/2

Model : TGF-5SD

ELECTRICAL DATA	
Voltage	115/60/1
Plug Type	ⓘ NEMA-5-15P
Full Load Amperes	5.5
Compressor HP	1/3
Cord Length ft.	7
Refrigerant	R-404A
DIMENSIONAL DATA	
# of Doors	1
Net Capacity cu. ft.	5.9
Ext. Length Overall in.	25 (635mm)
Ext. Depth Overall in.*	23 ¹ / ₄ (590mm)
Ext. Height Overall in.†	30 ¹ / ₂ (775mm)
Int. Length Overall in.	20 ⁵ / ₈ (525mm)
Int. Depth Overall in.	18 ³ / ₄ (475mm)
Int. Height Overall in.	26 ¹ / ₄ (665mm)
Gross Weight lbs.	185
Net Weight lbs.	170
# of Shelves	2
Shelf Size (LxD) in.	19 ³ / ₈ x 16 ⁵ / ₈

Design and specifications subject to change without notice.
Actual shipping weight may differ due to extra packing materials for product protection.
* Depth does not include 2-1/4" (57mm) for door handle.
Depth does not include 2-3/8" (60mm) for rear mechanical component.
† Height does not include 2-1/4" (56mm) for leg height.

- **WARRANTY : Exceptional 3 Year Parts and Labor Warranty
Additional 2 Year Warranty on Compressor**

- **THREE COLOR OPTIONS AVAILABLE**

- Black Cabinet
- White Cabinet
- White Cabinet with Wine Color Trim

- **DOOR LOCKING SYSTEM**

PLAN VIEW

(unit : inch)

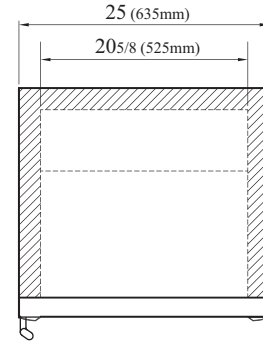

TOP VIEW

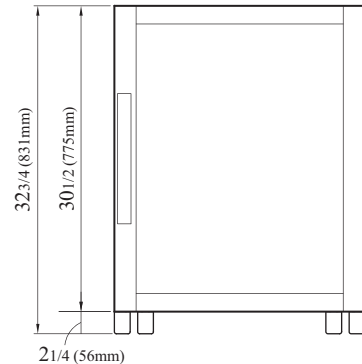

FRONT VIEW

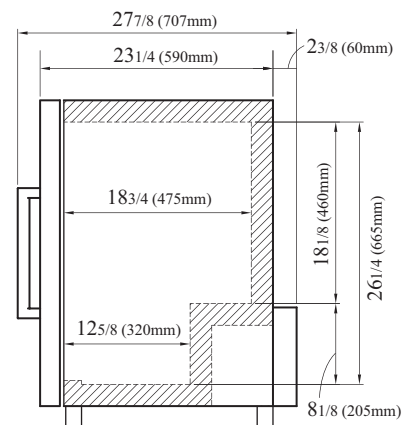

SIDE VIEW

Ver.201301



- Turbo Air : 800-627-0032
- GK : 800-500-3519
- Warranty : 800-381-7770
- AC : 888-900-1002