

**REFRIGERATOR MANUFACTURER**  
**Turbo air**  
 more durable, efficient, beautiful

1250 Victoria St  
 Carson, CA 90746  
 Tel. 310-900-1000  
 Fax. 310-900-1077  
[www.turboairinc.com](http://www.turboairinc.com)

Project :	
Model # :	
Item # :	Qty :
Available W/H :	
Approval :	

**Glass Door Freezer** Glass Door Merchandisers  
Super Deluxe Series

**Model : TGF-35SD**

**FEATURES / BENEFITS**

- **DIGITAL TEMPERATURE CONTROL SYSTEM**  
 Digital technology provides precise and constant temperatures throughout the cabinet. This allows food products to remain fresh over an extended period of time, reduces door maintenance and roller/bushing wear, and facilitates smooth door opening.
- **SMART DEFROST SYSTEM**  
 Generally, a refrigerator's defrost timer defrosts automatically for a fixed length of time regardless of the existing conditions of the refrigerator. This makes it difficult to maintain a constant temperature and also consumes unnecessary energy. Turbo Air's "Smart Defrost System" analyzes its surrounding environments and defrosts only when it is needed for the required time. This not only saves energy but also keeps the contents of the refrigerator safe.
- **NO ELECTRICAL FRAME HEATER IS NEEDED**  
 Turbo Air is the first in the industry to replace a frame heater with a method of using compressor-produced heat. This eliminates any unnecessary energy consumption while providing efficient freezing performance.
- **ENERGY CONSERVING FAN CONTROL**  
 Utilizing algorithmic air circulation for optimal temperature levels, our innovative fan control system conserves energy by at least 15% and increases compressor life by up to 30%.
- **LED LIGHTING INTERIOR DISPLAY SYSTEM**  
 Brighter and longer lasting LED lights provide attractive, enhanced illumination compared to fluorescents. It saves energy by producing less heat, while maximizing the visibility in the display area.
- **SHADOW FREE ADVERTISING PANEL**  
 Turbo Air is the pioneer in the refrigerator industry on applying special LED Light Guided Panels (LGP). LGP increases panel visibility and eliminates shadows, thus enhances any store atmosphere with eye-catching effects. LED lighting offers 10 times longer lasting life than fluorescents and conserves energy as well.
- **DOOR OPENING ALARM**  
 If the doors are not tightly closed, the refrigerator will not run. This would cause the cold air to escape through the opening, making food products spoil inside the cabinet. To prevent this problem, our refrigerators are equipped with the Door Alarm System that will sound if the doors are left open for more than 30 seconds.
- **EARLY WARNING SYSTEM**  
 Malfunctions are generally recognized when an increase in temperature is detected, 2 to 3 hours after the refrigerator had stopped running. This causes the user to become aware of malfunction issues the next morning in which the contents may have already spoiled. To eliminate this, Turbo Air units have a warning system in place that diagnose and monitor itself for risk factors, which gives early warning signals to allow for preserving contents and for preventing future problems.
- **TRIPLE PANE AIR INSULATED LAYER GLASS DOORS**  
 Equipped with unique triple pane glass doors with a layer of patented, transparent thermal insulating film applied between the glass layers. Lightweight door construction reduces door maintenance and roller/bushing wear, and facilitates smooth door opening.

**EXCEPTIONAL 3 YEAR PARTS & LABOR WARRANTY**



■ **FREEZER HOLDS -15°F ~ 5°F FOR THE BEST IN FROZEN FOOD PRESERVATION**



Model	Swing Door	CU./FT.	#of Shelves	HP	AMPS	Crated Weight (lbs.)	L x D* x H† (inches)
<b>TGF-35SD</b>	<b>2</b>	<b>37.0</b>	<b>8</b>	<b>1 1/4</b>	<b>12.0</b>	<b>510</b>	<b>39 1/2 x 31 7/8 x 77</b>

## Model : TGF-35SD

ELECTRICAL DATA	
Voltage	115/60/1
Plug Type	 NEMA-5-20P
Full Load Amperes	12.0
Compressor HP	1 1/4
Cord Length ft.	7
Refrigerant	R-404A
DIMENSIONAL DATA	
# of Doors	2
Net Capacity cu. ft.	37.0
Ext. Length Overall in.	39 1/2 (1004mm)
Ext. Depth Overall in.*	31 7/8 (809mm)
Ext. Height Overall in.†	77 (1956mm)
Int. Length Overall in.	35 5/8 (904mm)
Int. Depth Overall in.	27 1/2 (699mm)
Int. Height Overall in.	60 3/8 (1535mm)
Gross Weight lbs.	510
Net Weight lbs.	480
# of Shelves	8
Shelf Size (LxD) in.	18 x 23 3/8

Design and specifications subject to change without notice.  
Actual shipping weight may differ due to extra packing materials for product protection.  
\* Depth does not include 2-1/4" (57mm) for door handle.  
† Height does not include 2-1/2" (63mm) for leg height.

■ **WARRANTY :** Exceptional 3 Year Parts and Labor Warranty  
Additional 2 Year Warranty on Compressor

■ **THREE COLOR OPTIONS AVAILABLE**

- Black Cabinet
- White Cabinet
- White Cabinet with Wine Color Trim

■ **DOOR LOCKING SYSTEM STANDARD**

■ **PRICE TAG ATTACHABLE SHELF AVAILABLE (OPTIONAL)**

■ **MODERN DESIGN**

By harmonizing curvature and rigidity, our modern style product designs are user-friendly while maintaining the highest product visibility and aesthetics.

■ **SOUND SYSTEM**

plays music and recorded greetings when customer opens the doors

## PLAN VIEW

(unit : inch)

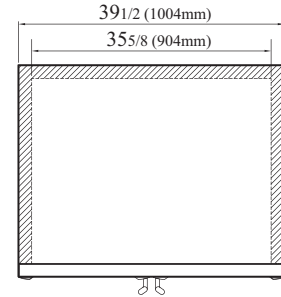

TOP VIEW

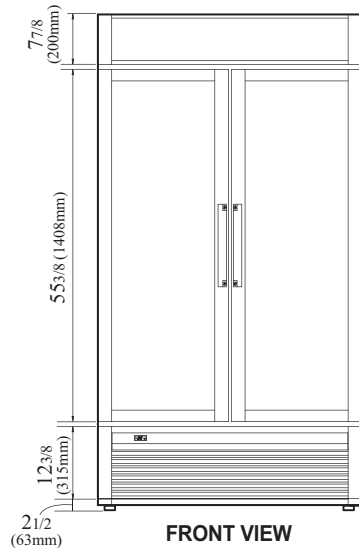

FRONT VIEW

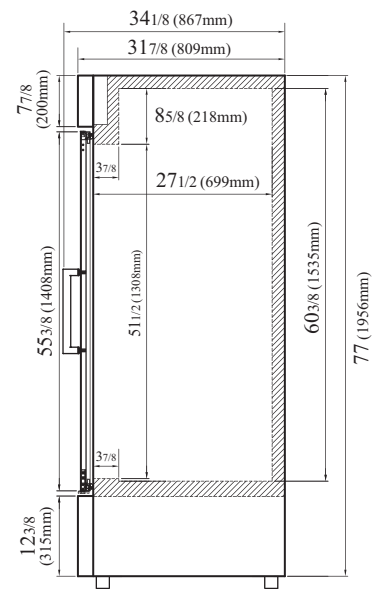

SIDE VIEW

Ver.201308



■ Turbo Air : 800-627-0032 ■ GK : 800-500-3519  
■ Warranty : 800-381-7770 ■ AC : 888-900-1002