



NOR-LAKE, INCORPORATED
727 Second Street
Hudson, Wisconsin 54016

800-955-5253
715-386-2323
866-961-5253 Parts
800-388-5253 Service
715-386-6149 FAX
www.norlake.com

ADVANTEDGE™ REACH-IN REFRIGERATORS



PROJECT:
.....
ITEM NUMBER:
.....
MODEL NUMBER:
.....

SPECIFICATIONS FOR: NLR23-S, NLR49-S, NLR72-S

- **Exterior Finish:** Exterior front sides and doors are stainless steel. Exterior top, bottom and back are galvanized steel.
- **Interior Finish:** Interior liner and interior door panel are stainless steel.
- **Insulation:** The complete cabinet and door(s) are foamed-in-place with polyurethane foam insulation.
- **Hardware:** Heavy duty, pivot hinges; key locks; curved handle with recessed pocket; self adjusting magnetic gaskets; 4" dia. casters (4 casters on one and two door models and 6 casters on three door model). 4 vinyl coated shelves per door section - standard.
- **Electrical:** An interior incandescent light is activated by a switch for each door.
- **Instrumentation:** Microprocessor with digital display allows temperature adjustment at control panel.
- **Refrigeration:** Complete bottom mounted refrigeration system with a copper tube, ceiling mount aluminum fin evaporator. The condensate is collected and automatically evaporated from an energy efficient air over wick style vaporizer. Drain line is recessed in cabinet back. Refrigerant flow is controlled by a capillary tube. R-134a refrigerant in NLR23 and NLR49, R404a in NLR72. Operating temperature range: +34°F to +38°F.
- **Approvals:** UL, C-UL, ETL Sanitation, and ENERGY STAR® Listed.

STANDARD FEATURES

- Air-cooled condensing unit
- Automatic condensate vaporizer
- Automatic defrost
- Casters
- Capillary tube system
- Curved handle with recessed pocket
- Door open alarm
- Interior light
- Key locks
- Magnetic gasket
- Microprocessor with digital display
- Operating temperature range: +34°F to +38°F

OPTIONAL FEATURES*

- Polyurethane insulation
- R-134a refrigerant for NLR23 & NLR49
- R-404a refrigerant for NLR72
- Stainless steel interior and exterior
- Vinyl coated shelves
- UL, C-UL, ETL Sanitation & ENERGY STAR® listed.
- Warranties: 3 year parts and labor, 5 year compressor
- Extra shelves
- Field reversible hinge kit for single door models (part # 146524)
- Pan slide rack (part # 146515)

* Most options are available two weeks from receipt of order. Please contact us for specific questions.

** C-UL is Underwriters Laboratories Safety Certification Mark which indicates that UL has tested the equipment to applicable CSA Standards.

** ETI-Sanitation is Intertek Laboratories Safety Certification Mark which indicates that ETL has tested the equipment to applicable NSF Standards.

1, 2 & 3 DOOR REFRIGERATORS

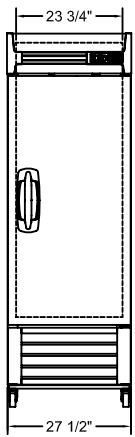

NLR23-S
FRONT

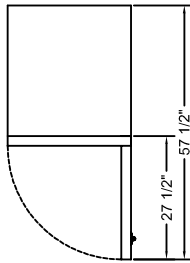

NLR23-S
TOP

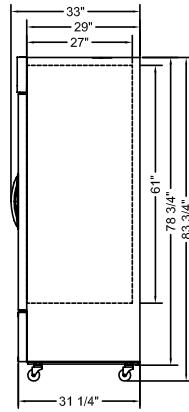

SIDE VIEW
ALL MODELS

SPECIFICATIONS

Models	NLR23-S	NLR49-S	NLR72-S
Crated Weight (lbs) (kg)	308 (139)	483 (217)	653 (294)
Crated Height (in) (cm)	84-1/4 (211)	84-1/4 (211)	84-1/4 (211)
Crated Width (in) (cm)	29-1/8 (73)	56-3/4 (142)	78-3/8 (196)
Crated Depth (in) (cm)	33-1/2 (84)	33-1/2 (84)	33-1/2 (84)
Interior Height (in) (cm)	61 (153)	61 (153)	61 (153)
Interior Width (in) (cm)	23-3/4 (59)	51-1/2 (129)	74-1/4 (186)
Interior Depth (in) (cm)	27 (68)	27 (68)	27 (68)
Overall Height (in) (cm) *	83-3/4 (209)	83-3/4 (209)	83-3/4 (209)
Overall Width (in) (cm)	27-1/2 (69)	55-1/4 (138)	78 (195)
Overall Depth (in) (cm)	33 (83)	33 (83)	33 (83)
Gross Cubage (CuFt) (L)	23 (651)	49 (1387)	72 (2002)
Number of Shelves	4	8	12
Shelf Area (SqFt) (Sqm)	18 (1.67)	39 (3.6)	56.5 (5.25)
Number of Casters	4	4	6
Condensing Unit Size	1/3 HP	1/3 HP	3/5 HP
Refrigerant	R-134a	R-134a	R-404a
Electrical Characteristics	115/60/1	115/60/1	115/60/1
Cord & Plug Furnished	Yes	Yes	Yes
NEMA Plug Configuration	5-15P	5-15P	5-15P
Total Amp Draw	7.5	7.5	10.0

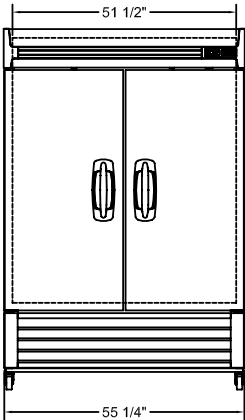

NLR49-S
FRONT

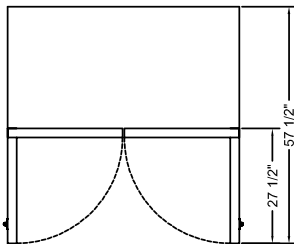

NLR49-S
TOP

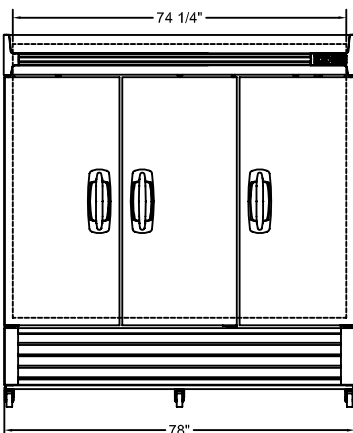

NLR72-S
FRONT

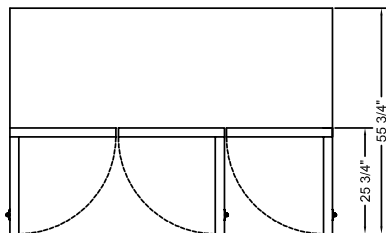

NLR72-S
TOP

Specifications subject to change without notice.

* The overall heights shown in the table and drawings are with casters.



Revision Date: 12/17
Part Number: 143381