

All Metal Commercial Food Processor

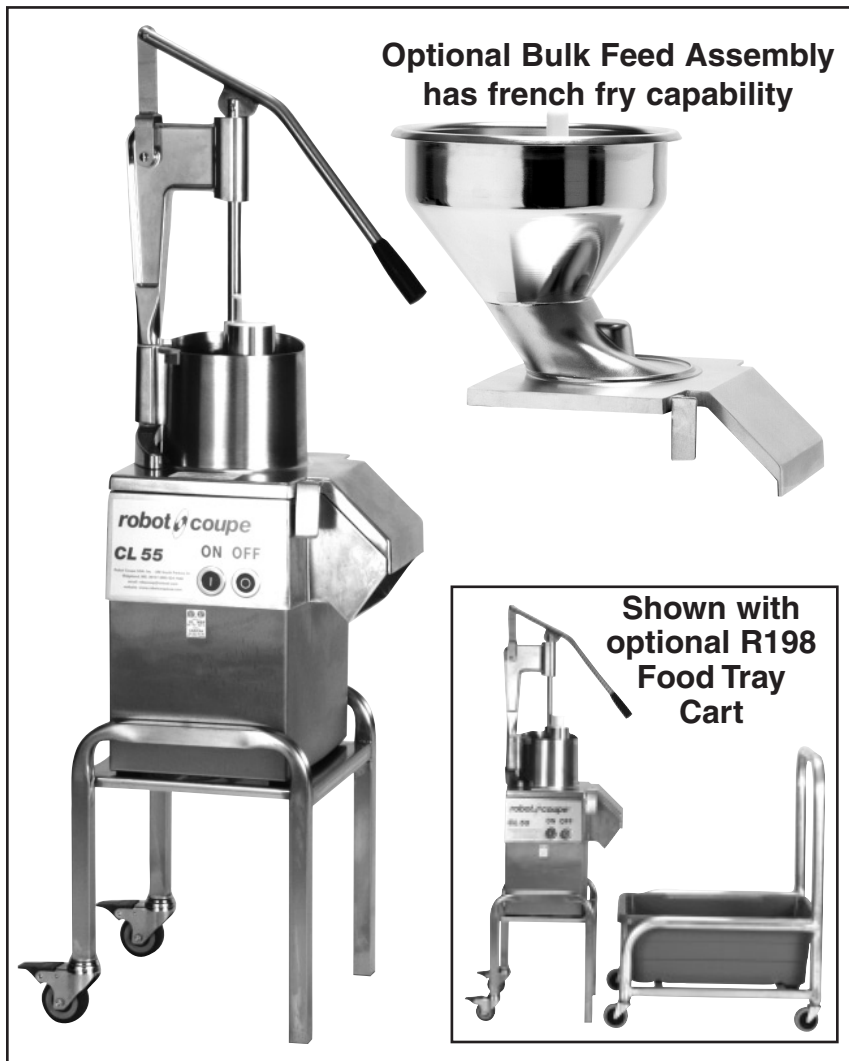

Prepare 1200 servings in 3 hours or less.

Process whole heads of cabbage, lettuce, bulk cheese, etc. Unit yields consistent professional quality cuts for restaurants, institutions,

delicatessens, caterers, fast food restaurant and food manufacturers.



- All metal construction.
- "Whole head" large feed opening and small built-in feed opening for carrots, celery, etc.
- "On-Off" pusher-type switch, plus magnetic safety switch to stop motor when cover or pusher feed is opened.
- Feed lead specially designed for easy removal and cleaning. Optional bulk feed assembly available.
- A complete collection of cutting discs, including slicers, waved slicers, graters, julienne, french fry and dicing grids. Uses 39 (bulk) or 37 (pusher) different processing discs.
- Comes with stainless steel stand with casters for easy maneuverability.
- 1 year parts and labor warranty.

Robot Coupe U.S.A., Inc.

P.O. Box 16625

Jackson, MS 39236-6625

1-800-824-1646 • (601) 898-8411

FAX: (601) 898-9134

www.robotcoupeusa.com • e-mail: info@robotcoupeusa.com

SPECIFICATIONS ON REVERSE SIDE

Specifications

STANDARD PACK: CL55D Pusher

Includes motor base unit, all-metal "pump handle" feed unit mounted on stainless steel stand with casters, one medium 1/8" (3mm) grating disc and one 1/8" (3mm) slicing disc.

ELECTRICAL: 120V, 60Hz, 12.0 Amps, single phase. Contact your local electrician for local code requirements.

MOTOR: 3 HP, 425 RPM.

WEIGHT: 86 lbs. approximate shipping weight.

STANDARDS: ETL electrical & Sanitation, cETL (Canada)

PROCESSING DISCS

* For Series D machines only

Slicing Discs

C444SA	1/32" (1mm)
C445SA	5/64" (2mm)
C446SA	1/8" (3mm)
C477SA	5/32" (4mm)
28128*	3/16" (5mm)
28129*	5/16" (8mm)
28130*	3/8" (10mm)
28131*	9/16" (14mm)
C422SA	3/4" (19mm)
28132*	25/32" (20mm)
28133*	1" (25mm)

Grating Discs

C494GPA	1/16" (1.5mm)
C451GPA	5/64" (2mm)
C450GPA	1/8" (3mm)
C475GPA	5/32" (4mm)
C453GPA	3/16" (5mm)
C478GPA	9/32" (7mm)
C433GPA	11/32" (9mm)
C495GPA	Fine Pulping
C452GPA	Hard Cheese Grate

Julienne Discs

C460JA	5/64" x 5/64" (2mm x 2mm)
C483JA	5/64" x 5/32" (2mm x 4mm)
C484JA	5/64" x 1/4" (2mm x 6mm)
C486JA	5/64" x 5/16" (2mm x 8mm)
C462JA	5/32" x 5/32" (4mm x 4mm)
C438JA	1/4" x 1/4" (6mm x 6mm)
C466JA	5/16" x 5/16" (8mm x 8mm)

French Fry Kits

28134*	5/16" (8mm)
28135*	3/8" (10mm)

Ripple Cut Slicers

C445W	5/64" (2mm)
C446W	1/8" (3mm)
C464W	3/16" (5mm)

Romaine Lettuce Kit

28133/104031	2"
--------------	----

Dicing Kits

28110	3/16" x 3/16" (5mm x 5mm)
28111	5/16" x 5/16" (8mm x 8mm)
28112	3/8" x 3/8" (10mm x 10mm)
28113	9/16" x 9/16" (14mm x 14mm)
28114	25/32" x 25/32" (20mm x 20mm)
28115	1" x 1" (25mm x 25mm)

CL55 Pusher

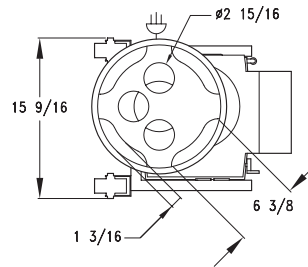
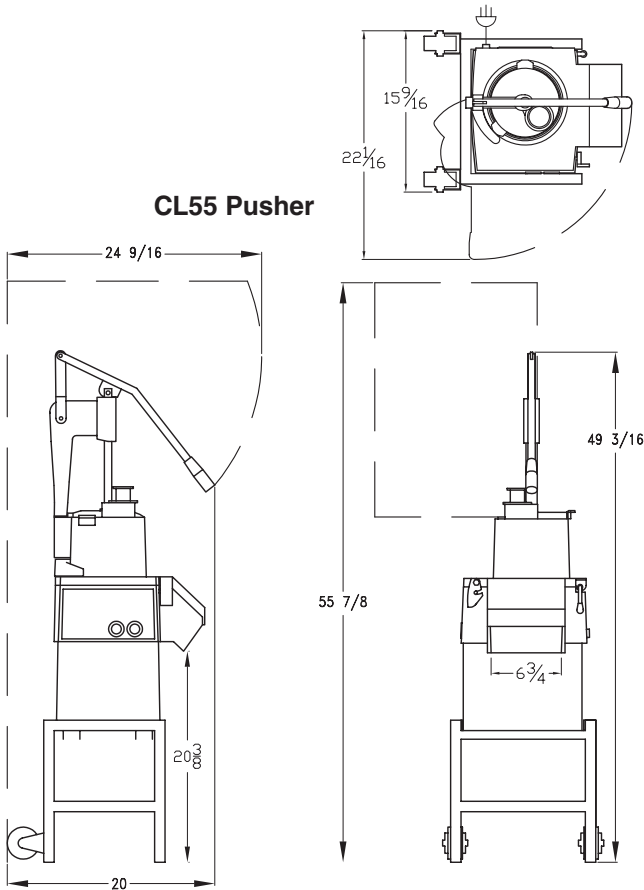

R255
Plate Rack

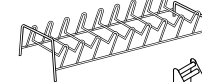

R475
Single
Plate Rack

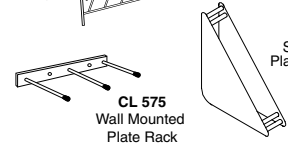

CL 575
Wall Mounted
Plate Rack

CL55 Bulk

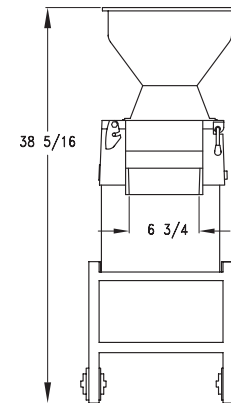
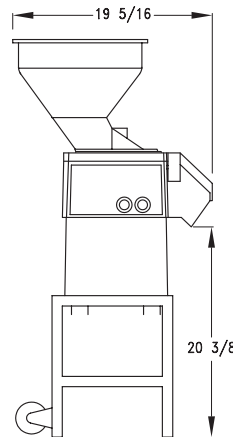

Robot Coupe U.S.A., Inc.

P.O. Box 16625

Jackson, MS 39236-6625

1-800-824-1646

(601) 898-8411

FAX: (601) 898-9134

www.robotcoupeusa.com

e-mail: info@robotcoupeusa.com

Distributed by: